

INTEGRAL KERB AND GUTTER
FOR NEW & REPLACEMENT KERB

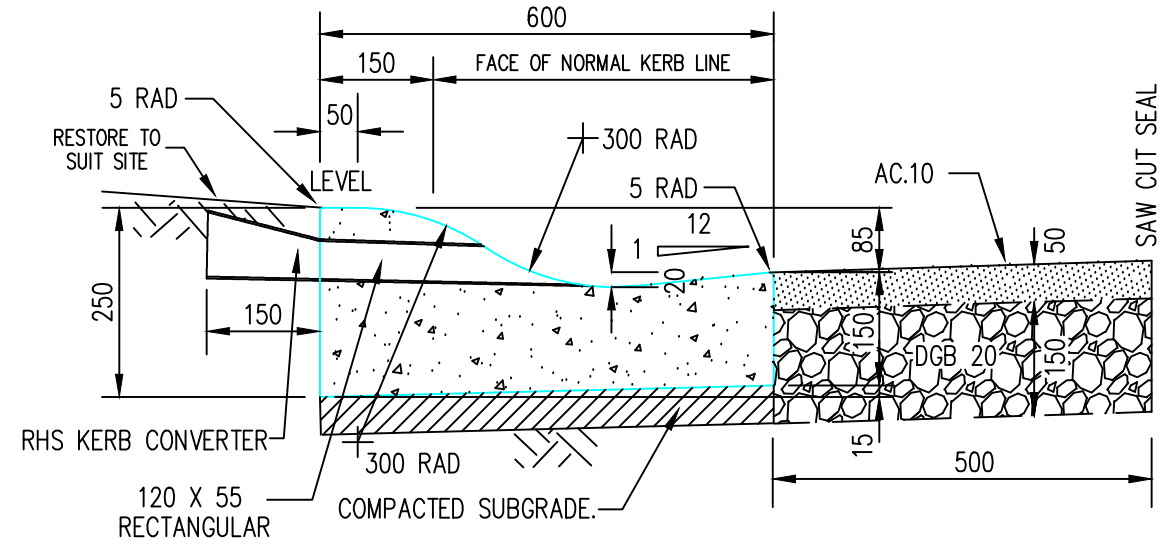

ROLLTOP KERB AND GUTTER
FOR NEW & REPLACEMENT KERB

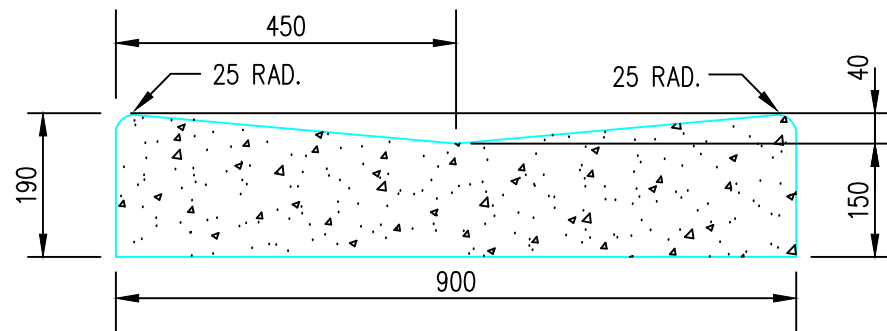

DISH CROSSING

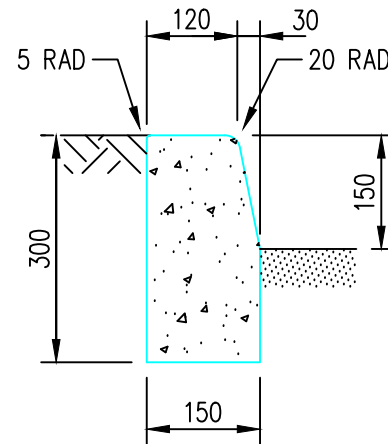

KERB ONLY

NOTES:

1. EXPANSION JOINTS SHALL BE PLACED AT INTERVALS OF NOT MORE THAN SIX METRES OR AT JUNCTIONS WITH VEHICLE CROSSINGS AND DRAINAGE PITS.
2. HOLES SHALL BE MADE THROUGH THE KERB FOR THE PURPOSE OF ALLOWING ALLOTMENT DRAINAGE. ONE DRAINAGE HOLE SHALL BE PROVIDED INSIDE THE LOWER BOUNDARY LINE OF EACH ALLOTMENT OR AS DIRECTED BY THE ENGINEER.
3. MOULD SHAPE MAY BE VARIED AT ENGINEERS DISCRETION.

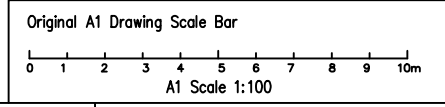

Rev.	DESCRIPTION	APPROVED	DATE
A	STANDARD REVIEWS PANEL	M.K.	06/2018
AMENDMENTS			

LEGEND			
▲ SURVEY CONTROL STATION	AV AIR VALVE	○ LP LIGHT POLE	▨ RURAL/JUNCTION PIT
● PM PERMANENT MARK	OH HYDRANT	○ PP POWER POLE	▩ HEADWALL
○ RM REFERENCE MARK	○ SV STOP VALVE	○ SP SERVICE POLE	
□ PEG	□ S SEWER MAN/HOLE	▬ UNDERGROUND ELECTRICAL CABLE	☒ PHONE PHONE BOX
● MKK SURVEY MARK	▩ T TELSTRA PIT	▬ GAS PIT	
○ SHRUB	▩ LARGE TELSTRA PIT		
○ TREE			

Approved by - date	M.KOCOSKI-29/06/2018
Autocad:	6000-R-01A.DWG
Chkcode:	N/A

THE COUNCIL OF THE CITY OF BLUE MOUNTAINS		
SCALE: 1:10	DATUM: N/A	ORIGIN: N/A
Surveyed: N/A	Design: M.K.	
Drawn: M.K.	Checked: M.K.	

INFRASTRUCTURE & STRATEGIC ASSETS / DESIGN & SURVEY	
KERB AND GUTTER DETAILS	

Job Folder No:	TS\LIBRARIES\DESIGN\LIBRARY\STAND_DRAWINGS\8000-ROADS
Revision:	A Sheet Size: A3
Drawing No:	6000-R-01A
SHEET 1 OF 1 SHEETS	