

Erratum

**To Item 15 of Business Paper (the
'main report') for the Ordinary
Meeting of 26 June 2007**

X04/1225

**Lot 6 DP 4216, Lots 70 and 71 DP
718623 and Lot 1 DP 224782, Nos. 12-20
Ross Street, Glenbrook**

ITEM NO: 15—ERRATUM

SUBJECT: DEVELOPMENT APPLICATION NO. X04/1225 FOR A MIXED USE DEVELOPMENT CONSISTING OF RETAIL, COMMERCIAL AND RESIDENTIAL UNITS ON LOT 6 DP 4216, LOTS 70 AND 71 DP 718623 AND LOT 1 DP 224782, NOS. 12-20 ROSS STREET, GLENBROOK.

FILE NO: X04/1225

Recommendation:

That Development Application No. X04/1225 for a mixed use development consisting of retail, commercial and residential uses on Lot 6 DP 4216, Lots 70 and 71 DP 718623 and Lot 1 DP 224782, Nos. 12-20 Ross Street, Glenbrook be determined pursuant to Section 80 of the Environmental Planning and Assessment Act 1979 by the granting of consent subject to conditions shown in Attachment 1 to this Report.

Report by Group Manager, Environmental and Customer Services:

This Report is an Erratum to Item 15 of the Business Paper (the 'main report') for the Ordinary Meeting of 26 June 2007.

The Report was completed before the inadvertent omission of a Plan being Drawing No. 0303/DA/02E was identified.

Therefore, this Plan is hereby shown as Attachment 1 to this Report for your information and consideration. An A3 copy of this plan together with Plan No. 0313/DA/01B was provided to Councillors on 15 June 2007.

Attachment 1—Site Plan

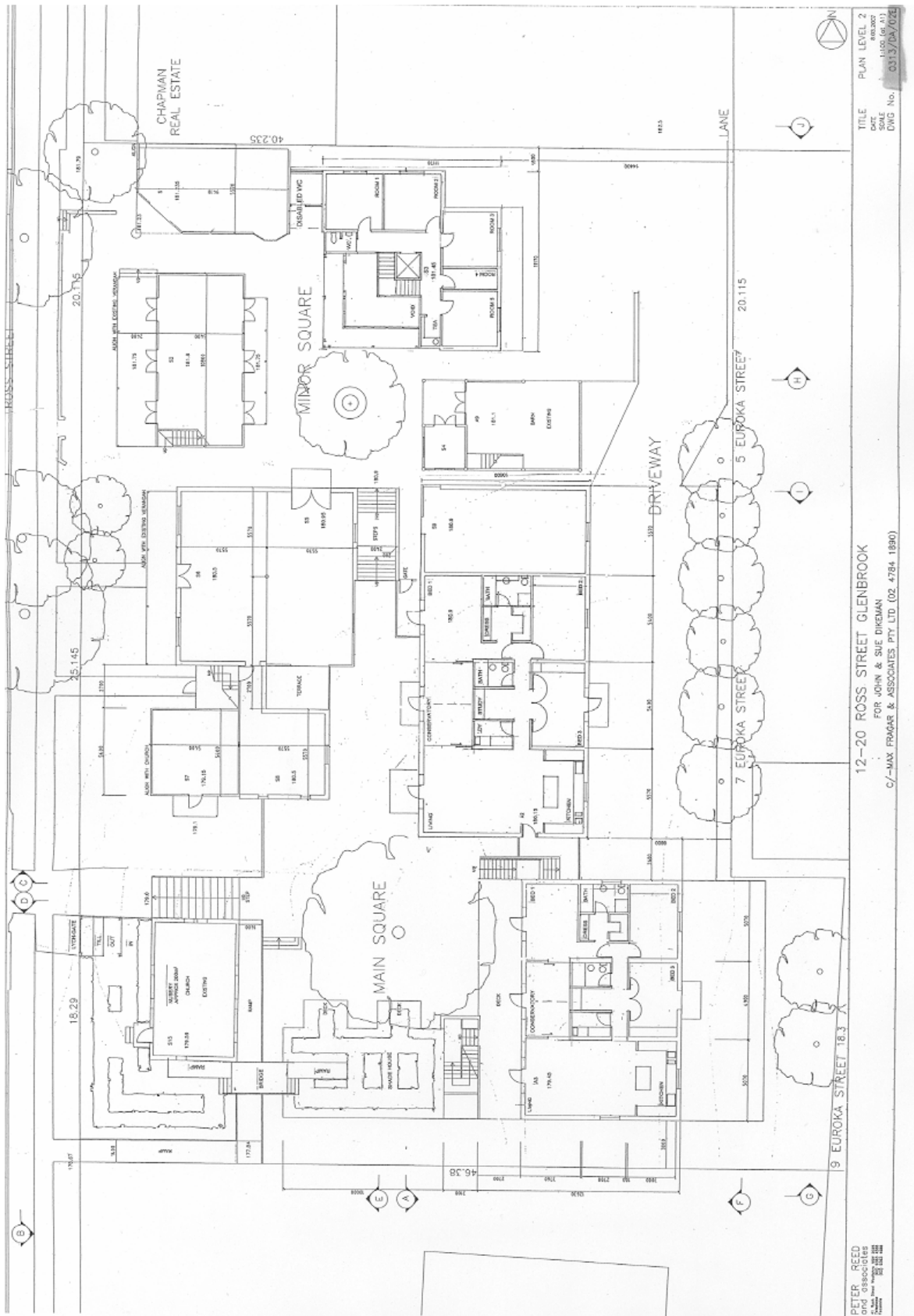

TITLE PLAN LEVEL 2
 DATE 11.05.04
 SCALE 1:100
 DWG No. 0313/DA/02E

12-20 ROSS STREET GLENBROOK
 FOR JOHN & SUE DREMAN
 C/- MAX FRAGER & ASSOCIATES PTY LTD (02 4784 1890)

PETER REED
 and associates
 ARCHITECTS
 10/110 ROSS STREET
 GLENBROOK NSW 1511
 PH (02) 4784 1890
 FAX (02) 4784 1891
 WWW.PETERREED.COM.AU